

Date stool specimen was taken

Please fill in the date when the stool specimen was taken and add this note to the shipping envelope!

Instructions for taking stool specimen using the stool specimen tube

Design of the stool specimen tube

Liquid filled stool specimen tube

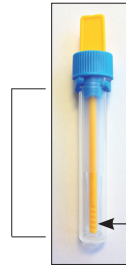

Yellow: Dosing stick with snap closure

Blue: Cone insert to remove excess stool

Dosing tip with ridges

1 Remove dosing stick

Unscrew the **upper yellow top** from the specimen tube and remove the attached dosing tip. The **blue cone insert remains locked on the tube!**

2 Taking stool sample

Insert the dosing stick **3-times** into different areas of the stool specimen. The ridges of the dosing tip should be filled with stool sample.

3 Return the dosing stick only once

Return the dosing stick and the adherent stool specimen **once** to the stool specimen tube and **do not remove again**. The excess specimen will be removed due to the narrow cone insert. Please note: Only the **small, defined amount** of stool on the dosing stick may enter the tube. Then screw on the yellow cap so that the snap indicating closure is audible.

Please note: The stool solution inside the tube shows almost no change in color. If, however, you repeat the sampling procedure more than once, the stool solution will change color due to the excess amount of stool added, resulting in either **the sample can no longer be measured or a false positive will be reported!**

4 Return of the stool specimen

After taking the sample as described in point 1-3, please return the stool specimen to your attending physician or clinic on the same day or, latest, the following day.

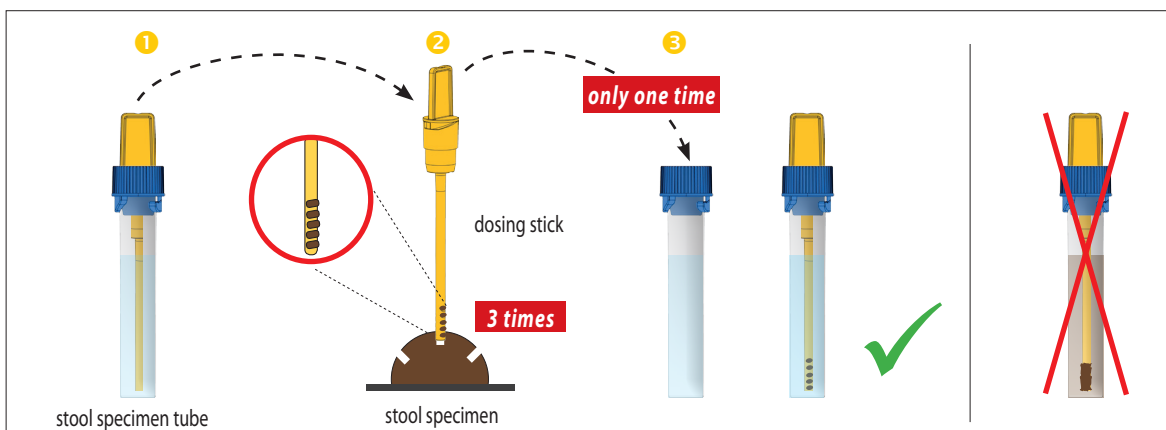

Immundiagnostik AG
Stubenwald-Allee 8a
64625 Bensheim, Germany
Phone: +49 (0) 62 51/70 19 00
Fax: +49 (0) 62 51/84 94 30
info@immundiagnostik.com
www.immundiagnostik.com



Barcode